

# THE BUILDINGS OF MOREFA BORTH

- the Marsh Harbour

Ceredigion



That part of Borth Village on a pebble bank with the sea on one side and the Cors Fochno marsh some reclaimed and the railway on the other. In the distance is the River Dyfi. Photograph Michael Lewis

Photographs and History by BERYL LEWIS

*This work is for research and educational purposes only.*

# THE FOURTH COTTAGE IN THE PWLL MAWR TERRACE

Morfa Borth - the Marsh Harbour

Still a home in 1881. A ruin about 1962. Now gone.



*ABOVE* About 1962 just a ruin was left alongside Gwelfor. This drawing is from a Frith Postcard. On the the left is Dovey Cottage and on the right is Gwelfor. Today it would have stood in the garden of Dovey Cottage.

This was on ground encroached by a master mariner John Hughes in 1822 and by 1829 the cottage was built. For the story of the beginnings of the terrace in which it stood - please see Llys.

In the Census's before 1881 it is not possible to find the occupiers of this cottage.

At the Census of 1881 a mariner's wife Jane Hughes aged 30 was in the cottage with her daughters Eliza Jane 6 and Kate a baby.

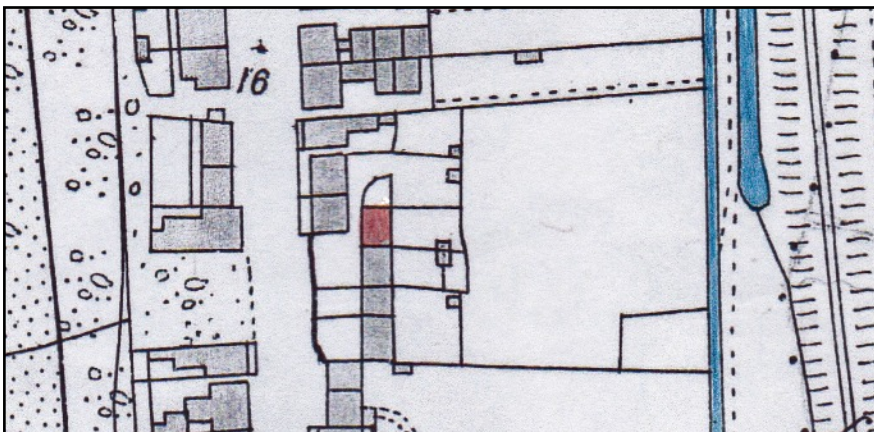

*LEFT* This was Jane Hughes's cottage in 1886 with its garden and the tiny building was probably its Ty Bach - outside lavatory (A detail from the 25 inch Ordnance Survey Map surveyed in 1886 and published in 1888, Cardiganshire NW III.10)

Archifdy Ceredigion Archives  
yn cyflwyno / presents  
**Tai'r Borth / Houses of Borth**  
gan/by Beryl Lewis  
[cyf/ref ADX/1629]

Mae **Tai'r Borth** yn cynnwys dros 350 hanes sy'n ymwneud ag adeiladau unigol ac mae'r hanesion wedi'u darlunio â chyfoeth o ffotograffau, mapiau a dogfennau. Mae'r ffeiliau ar gael ar ein gwefan: <https://www.archifdy-ceredigion.org.uk/tairborth.php?lang=cy>

Hoffem ddiolch i Beryl am fod mor garedig â chaniatáu i ni rannu ei gwaith â'r gynulleidfa ehangaf bosibl.

Ceidw Beryl Lewis yr hawlfraint yn ei gwaith ac mae'r hanesion yn cael eu rhannu at ddibenion preifat ac ymchwil yn unig.

**Houses of Borth** consists of over 350 histories of individual buildings, lavishly illustrated with photographs, maps and documents. All the files are available from our website: <https://www.archifdy-ceredigion.org.uk/tairborth.php>

We would like to thank Beryl for her kindness in letting us share her work with the widest possible audience.

Beryl Lewis retains the copyright in her work and the histories are made available for private use and research only.



Cyngor Sir  
**CEREDIGION**  
County Council



Archifdy  
Ceredigion  
Archives