

THE BUILDINGS OF MOREFA BORTH

- the Marsh Harbour

Ceredigion



That part of Borth Village on a pebble bank with the sea on one side and the Cors Fochno marsh some reclaimed and the railway on the other. In the distance is the River Dyfi. Photograph Michael Lewis

Photographs and History by BERYL LEWIS

This work is for research and educational purposes only.

VAN HYN

Morfa Borth, the Marsh Harbour

In the northern part of the village, on the east side of a back lane, built by on ground reclaimed from the bog as pasture, later the garden of the Cambrian Hotel, and now with rough grassland at the back. Built by 1934 possibly by the Roberts family.



ABOVE Van Hyn in February 2016.

Van Hyn is a bungalow under a gable roof parallel to the lane. It has red ridge tiles and no chimneys. There is an extension porch on the north side at right angles to the bungalow, with a front door opening into the yard. This extension has a matching roof which is not so tall. The walls of Van Hyn are rendered and the windows are modern. The south gable end of the bungalow does not have a window. In plan the main bungalow is the same as Rhosfryn next door! Adjoining the front is an extension with a double garage opening into the yard. Three roof lights suggest it has accommodation upstairs. The yard is hard standing and enclosed by a narrow rendered breeze block wall with a wide gateway. The bungalow almost fills its plot, but there is a narrow access to a garden at the back on the south side. Back windows of the bungalow will have a good view over the railway and the Cors Fochno bog to the hills beyond.

The granddaughter of Captain Davies who built Maesteg remembers that the ground behind it was owned by Mary Roberts. She was one of the family who owned the Garibaldi Draper's shop (now the Premier Stores) and other properties in Morfa Borth. They were an enterprising family. By 1924 Howard Lloyd Roberts had set up six hard tennis courts on this land (Cambrian News, May 30th) and by 1934 the family had five bungalows along the back lane for themselves and for tenants. Howard Lloyd Roberts owned Van Hyn and his tenant was A. M. Parry. There was a garage with the bungalow.

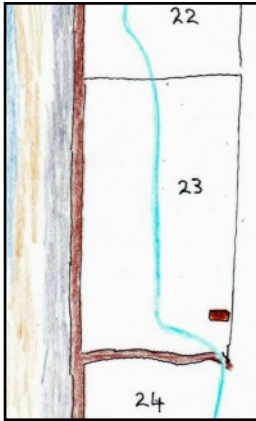

A. M. Parry paid the rates in 1938, and the place was valued at £7. In 1963 Miss Kimberly paid the Rates, by then increased to £16 suggesting some improvements had been made.

LEFT a detail copied from the map of 1829. (N.A. LRRO 1/3060)

The ground for this house was enclosed in 1809 by a local lawyer called Big John (John Lewis) from the pebble embankment thrown up by the sea, and called 'waste' because it was no use for farming, and the marsh ground beside it (also called 'waste') was reclaimed for pasture with drainage ditches. It was a field of 4 acres, 3 rods and 20 perches - that was almost five acres - and across it ran a brook on the old course of the River Leri. John Lewis had a cottage on it marked in red and called Terfynau (boundaries) – where the railway station is today. There were no other cottages. On a map of 1829 the ground was Number 23. A rent of £16 had to be paid every year to the Crown manor who owned the ground, but there was an option to buy it for twice that, and a note with the map said that John Lewis had bought it at a Manor Court Leet in 1809. The road had been there for centuries and was a turnpike road by the 1770s. It led to a ferry from Ynyslas to Aberdovey and was a quick way to North Wales.

John Lewis's land was sold to the developer Thomas Savin who brought the railway and built the Railway Station, the great Cambrian Hotel and Cambrian Terrace. The Hotel had large grounds (nearly two acres) for tennis, croquet, pleasure gardens, a bowling green, and possibly a walled garden. However, the Hotel did not do well, it had a hundred rooms, but often many were empty. It is likely that by the 1920s and 1930s it needed to raise

money by either selling off its roadside land to build the bungalows and houses, or having them built itself to sell. The owner of the then 'Grand Hotel' in 1930 were a Hotel and Land Development Company Ltd.

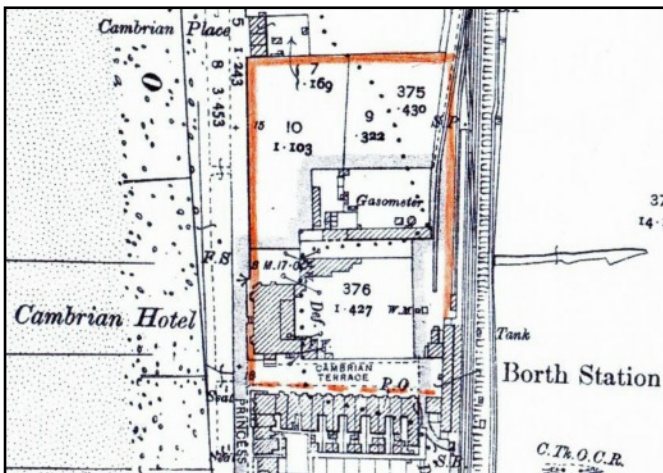

LEFT A detail from the 25 inch Ordnance Survey Map of 1905. Marked in red is John Lewis's former land. The house nearest the hotel ground in Cambrian Place is Bodlondeb.

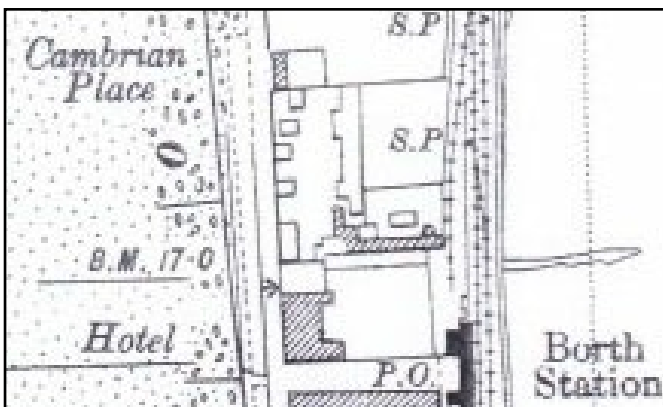

LEFT On this detail from a six inch Ordnance Survey Map of 1948 the place for the bungalows is marked, but there is no back lane, and no details of the gardens of each home (Map Ceredigion Archives)

Ernest Derricot paid the rates in 1949.

Paying the rates in 1957 was Mr Albert Webb Kimberly, and in 1963 he and Priscilla Kimberley had votes for the bungalow and were probably living there.

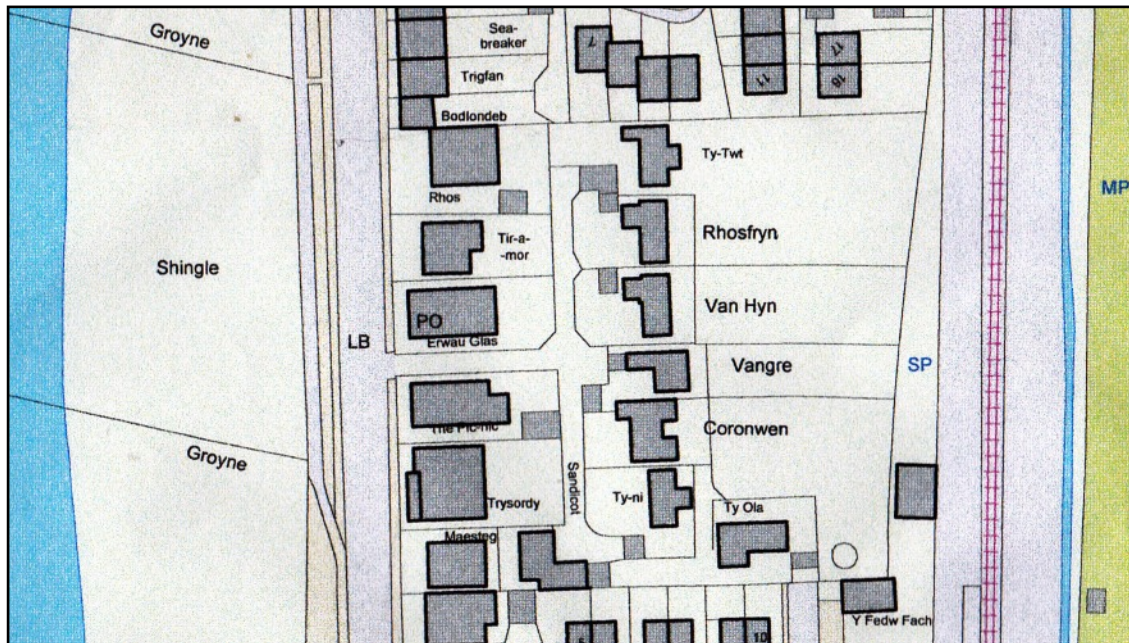

ABOVE A detail from a modern Council Map showing the row of bungalows.

(Map courtesy of Councillor Ray Quant who provided it for research for a village event).

Archifdy Ceredigion Archives
yn cyflwyno / presents
Tai'r Borth / Houses of Borth
gan/by Beryl Lewis
[cyf/ref ADX/1629]

Mae **Tai'r Borth** yn cynnwys dros 350 hanes sy'n ymwneud ag adeiladau unigol ac mae'r hanesion wedi'u darlunio â chyfoeth o ffotograffau, mapiau a dogfennau. Mae'r ffeiliau ar gael ar ein gwefan: <https://www.archifdy-eredigion.org.uk/tairborth.php?lang=cy>

Hoffem ddiolch i Beryl am fod mor garedig â chaniatáu i ni rannu ei gwaith â'r gynulleidfa ehangaf bosibl.

Ceidw Beryl Lewis yr hawlfraint yn ei gwaith ac mae'r hanesion yn cael eu rhannu at ddibenion preifat ac ymchwil yn unig.

Houses of Borth consists of over 350 histories of individual buildings, lavishly illustrated with photographs, maps and documents. All the files are available from our website: <https://www.archifdy-eredigion.org.uk/tairborth.php>

We would like to thank Beryl for her kindness in letting us share her work with the widest possible audience.

Beryl Lewis retains the copyright in her work and the histories are made available for private use and research only.



Cyngor Sir
CEREDIGION
County Council



Archifdy
Ceredigion
Archives